

**Key**

- ① Existing Decothane Base Coat with embedded Reemat Premium GFM
- ② Existing Decothane Top Coat as per Sika Liquid Plastics Project Specification
- ③ Sika Liquid Plastics Reactivation Primer applied 300mm beyond footplate of proposed steels
- ④ Sika Liquid Plastics Flexistrip applied to bolt heads
- ⑤ Sika Liquid Plastics Flexitape embedded and obliterated in a stripe coat of Decothane Base Coat and allowed to cure
- ⑥ New Decothane Base Coat with embedded Reemat Premium GFM as per ORIGINAL Specification
- ⑦ Decothane Top Coats as per ORIGINAL Sika Liquid Plastics Project Specification
- ⑧ Fully reinforced Decothane Waterproofing System dressed on to prepared and primed stanchions/penetrations/handrail systems in strict accordance with Sika Liquid Plastics Project Specification
- ⑨ Pre-fabricated stanchion/penetration/handrail system with proprietary termination cowl

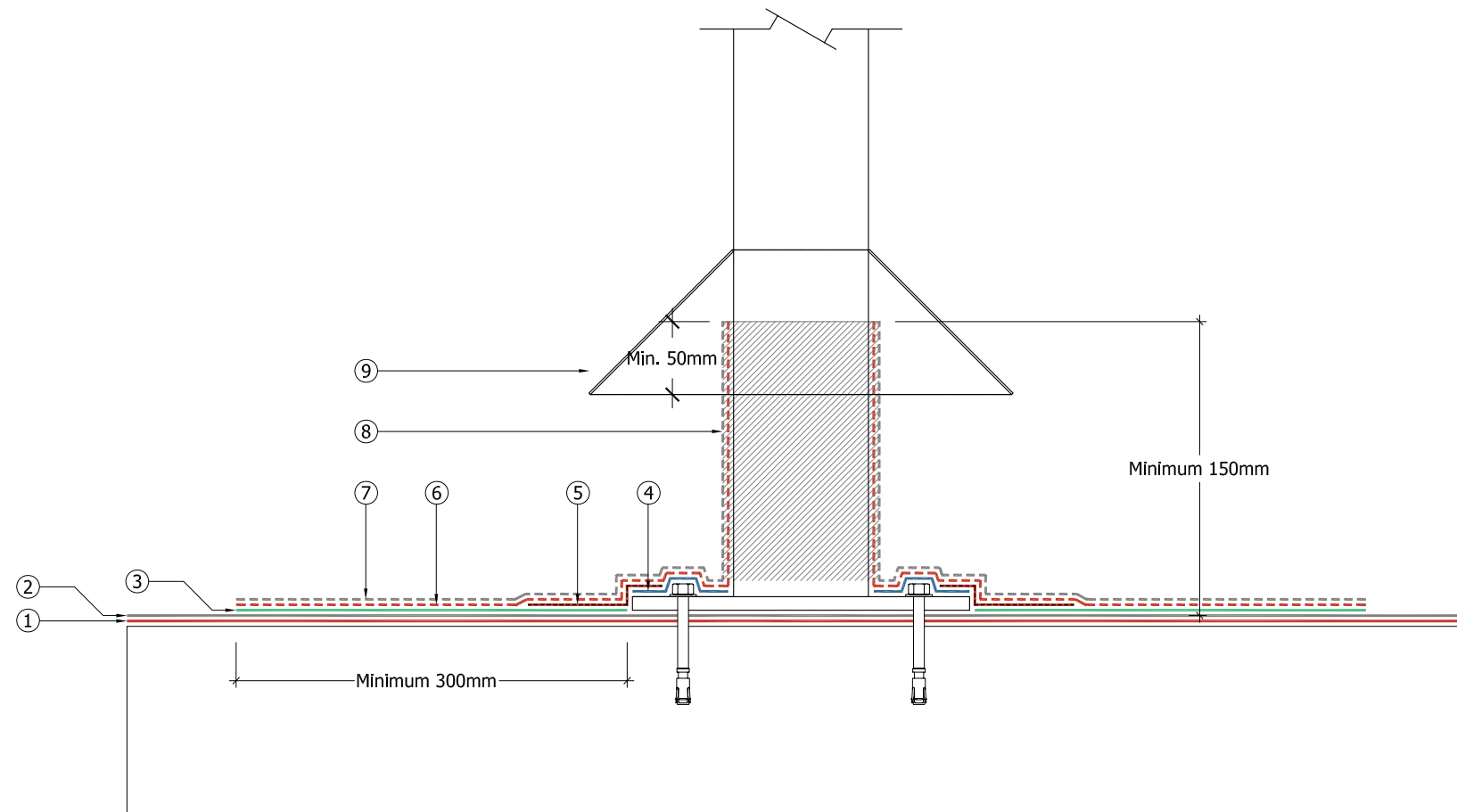

Sika Liquid Plastics  
 Sika House  
 Miller Street  
 Preston  
 Lancashire PR1 1EA  
 Telephone: 01772 259781  
 Email: [technical.customer.services@uk.sika.com](mailto:technical.customer.services@uk.sika.com)  
 Web: [www.liquidplastics.co.uk](http://www.liquidplastics.co.uk)

This drawing is solely intended to illustrate the correct application of Sika Liquid Plastics products and systems, it must be read in conjunction with the appropriate specification and current issue of relevant Technical Data Sheets. All elements bearing reference to structural and/or thermal design are shown indicatively and should not be used in whole or in part for any aspect of project design without consulting the relevant authorities.

For refurbishment projects, all aspects of the existing roof are deemed to be fully compliant with BS 6229:2003 (Code of Practice for Flat Roofs with Continuously Supported Coverings) or improved upon for instances where these standards are not met.

Site-specific details not covered by our range of Standard Details can be obtained by providing relevant information to the email address shown.

Project N<sup>o</sup>

DWG N<sup>o</sup> Revision

Project:

Drawing Title:  
 Waterproofing Application Detail  
 to a retrospectively fitted stanchion/  
 penetration/handrail system

Scale: NTS @ A3 Drawn:

Date:

